

10° TITANIUM VALVE SPRING RETAINERS

Engine Pro titanium valve spring retainers are engineered to perform under the most extreme conditions and are inspected to ensure precise tolerances.

- Manufactured from 6AL4V titanium alloy
- Made in the USA - your assurance of quality
- Light weight
- Machined and polished finish
- Call for other sizes and applications

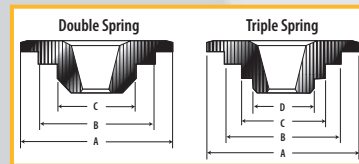

| PART # | SPRING O.D. | SPRING TYPE | VALVE STEM SIZE | A | B | C | D |
|-------------|---------------|-------------|-----------------|-------|-------|------|------|
| 03-1730-16 | 1.437 / 1.500 | DOUBLE | ALL | 1.437 | 1.065 | .700 | |
| 03-1731-16 | 1.500 / 1.550 | DOUBLE | ALL | 1.437 | 1.100 | .800 | |
| 03-1732-16 | 1.500 / 1.550 | DOUBLE | ALL | 1.500 | 1.110 | .710 | |
| 03-1733-16 | 1.625 | DOUBLE | ALL | 1.500 | 1.180 | .765 | |
| 03-1736-16 | 1.500 / 1.550 | TRIPLE | ALL | 1.500 | 1.135 | .835 | .635 |
| 03-1739-16 | 1.625 | TRIPLE | ALL | 1.500 | 1.180 | .870 | .635 |
| 03-1735-16* | 1.625 | TRIPLE | ALL | 1.500 | 1.180 | .870 | .635 |
| 03-1794-16 | 1.300 | BEEHIVE | ALL | 1.050 | .640 | | |

*+.050 INSTALLED HEIGHT OVER # 03-1739

STEEL VALVE SPRING RETAINERS

Engine Pro chrome moly steel retainers are designed to handle high pressures developed by new large diameter valve springs. Our retainers are manufactured to precise tolerances to ensure the springs are located properly. Available for 7 degree and 10 degree valve locks.

- 4140 chrome moly steel alloy
- CNC machined
- Heat treated
- Black oxide finish

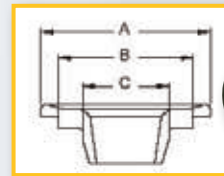

| PART # | SPRING O.D. | SPRING HEIGHT | KEEPER DEGREE | VALVE STEM SIZE | DIMENSIONS | | |
|-------------------|--------------------|---------------|---------------|-----------------|--------------|--------------|-------------|
| | | | | | A | B | C |
| 03-1000-16 | 1.250 | STD | 7 | 11/32" | 1.245 | .865 | .680 |
| 03-1001-16 | 1.250 | +.050 | 7 | 11/32" | 1.245 | .865 | .680 |
| 03-1017-16 | 1.275/1.325 | STD | 7 | 8mm | 1.240 | .940 | .640 |
| 03-1003-16 | 1.437/1.550 | STD | 7 | 11/32" | 1.440 | 1.050 | .700 |
| 03-1002-16 | 1.437/1.550 | STD | 10 | ALL | 1.440 | 1.050 | .700 |
| 03-1005-16 | 1.437/1.550 | STD | 7 | 3/8" | 1.440 | 1.050 | .700 |
| 03-1006-16 | 1.437/1.500 | STD | 10 | ALL | 1.400 | 1.060 | .690 |
| 03-1004-16 | 1.500/1.550 | STD | 10 | ALL | 1.437 | 1.100 | .800 |
| 03-1007-16 | 1.500/1.550 | +.100 | 10 | ALL | 1.500 | 1.115 | .690 |
| 03-1008-16 | 1.550 | +.100 | 10 | ALL | 1.500 | 1.105 | .710 |
| 03-1009-16 | 1.550 | +.100 | 10 | ALL | 1.500 | 1.120 | .705 |
| 03-1010-16 | 1.437/1.550 | +.100 | 7 | 11/32" | 1.440 | 1.050 | .700 |
| 03-1011-16 | 1.055 | STD | 7 | 8mm | 1.030 | 0.640 | BEEHIVE |
| 03-1012-16 | .959 | STD | 7 | STOCK | 0.930 | 0.630 | BEEHIVE |
| 03-1013-16 | 1.055 | STD | 7 | 11/32" | 1.030 | 0.640 | BEEHIVE |
| 03-1014-16 | 1.095 | STD | 10 | ALL | 1.050 | 0.640 | BEEHIVE |
| 03-1015-16 * | 1.055 | STD | 7 | 8mm | 1.030 | 0.640 | BEEHIVE |
| 03-1016-16 | 1.437/1.500 | STD | 7 | 11/32" | 1.400 | 1.030 | .690 |

* SAME AS 03-1011 BUT I.D. IS MACHINED FOR ADDITIONAL VALVE GUIDE CLEARANCE.

LASH CAPS

In extreme performance and racing conditions, lash caps are necessary to protect the valve tip from pounding caused by an engine running on the edge of valve float. Lash caps must be used with titanium valves.

- CNC Machined From Hardened 8620 Steel
- Finish Lapped to Insure a Parallel Plane
- EDM Oil Hole Prevents Friction Welding of Cap to Valve
- Black Oxide Finish / Made In The USA

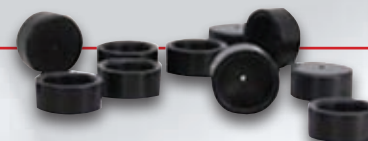

| PART # | DESCRIPTION | OVERALL HEAD HEIGHT | THICKNESS | VALVE STEM SIZE |
|------------|-------------------|---------------------|-----------|-----------------|
| 04-1620-16 | HARDENED LASH CAP | .230 | .080 | 5/16" |
| 04-1621-16 | HARDENED LASH CAP | .210 | .080 | 11/32" |
| 04-1622-16 | HARDENED LASH CAP | .190 | .080 | 3/8" |